

3016 .118" (3.0mm) CRIMP TERMINAL

Features:

- * THICKNESS: 0.2mm
- * MATES WITH: 3016H SERIES HOUSING
- * ACCEPTS WITH: 3015 TERMINAL

unit:mm

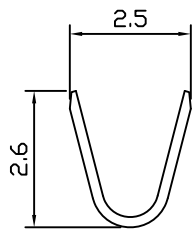

Section A-A'

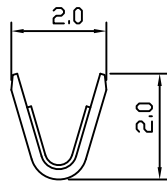

Section B-B'

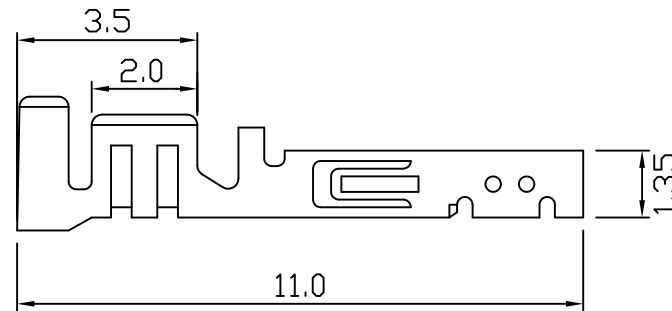
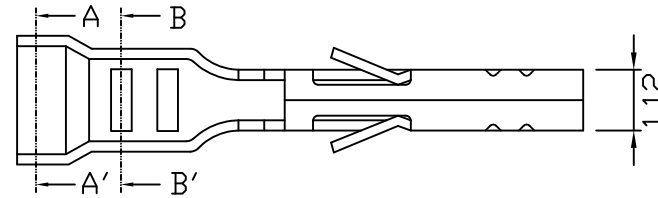

PART NO.	WIRE RANGE	MATERIAL	FINISH	QTY/REEL
3016	AWG#20-24	Phosphor bronze	Tin-plated	6,000 PCS